



WHEEL ASSEMBLY  
SCALE 1:1



WHEEL ASSEMBLY (ALT VIEW)  
SCALE 1:1

LEGEND:  
 ∅ DIAMETER  
 R RADIUS  
 ° DEGREES

PARTS LIST

ITEM	QTY	PART NAME	MATERIAL	DESCRIPTION
1	1	SHAFT	STEEL	
2	1	BUSHING	BRONZE	OILESS
3	1	HUB	ALUMINUM	
4	1	COLLAR	ALUMINUM	
5	2	PANEL RING	ALUMINUM	.12" UNIFORM THICKNESS
6	1	WHEEL	HARD RUBBER	
7	6	RIVETS	STANDARD	∅.31 1.00" INSIDE LENGTH, EQUALLY SPACED
8	2	WASHERS	STANDARD	I.D. ∅1.00" O.D. ∅2.12", .18 THICK
9	1	SPRING CLIP	STANDARD	∅.25 1.875" LONG

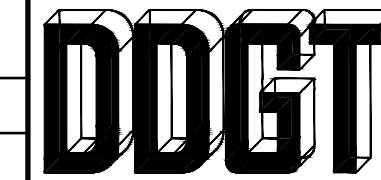

DIGITAL DESIGN  
GRAPHICS  
TECHNOLOGY

WWW.DDGT.NET

GENERAL NOTES:  
 ALL FILLETS HAVE R.12" UNLESS OTHERWISE NOTED.  
 ALL CHAMFERS ARE .06 X 45° UNLESS OTHERWISE NOTED

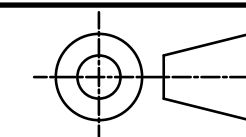

TOLERANCES UNLESS SPECIFIED:  
 DECIMAL INCHES:  
 X = ±.020  
 XX = ±.010  
 XXX = ±.005  
 FRACTIONAL ±1/64"  
 ANGLES ±1 DEGREE  
 SURFACES 32/

CLASS: DDGT 121

ASSIGNMENT #: 09

AUTOCAD DRAWING NAME:  
WHEEL ASSEMBLY

FIG #: 11-55

MANAGER: G. STROMMEN

DRAFTER: A. MOSTAFA

DATE: 2/21/2023

SCALE: AS NOTED

PAGE #: 1 OF 3

REV #	DATE	DESCRIPTION	APPROVED BY	PAGE #
3	2/21/2023	INSIDE DIAMETER OF PANEL RING CHANGED FROM ∅2.80" TO ∅2.70"	G. STROMMEN	3
2	2/21/2023	CENTERLINE DIAMETER FOR RIVET PATTERN CHANGED FROM ∅3.5" TO ∅3.94"	G. STROMMEN	3
1	2/21/2023	TAPER ANGLE ON WHEEL CHANGED FROM 5° TO 3.5°	G. STROMMEN	3

REVISION TABLE

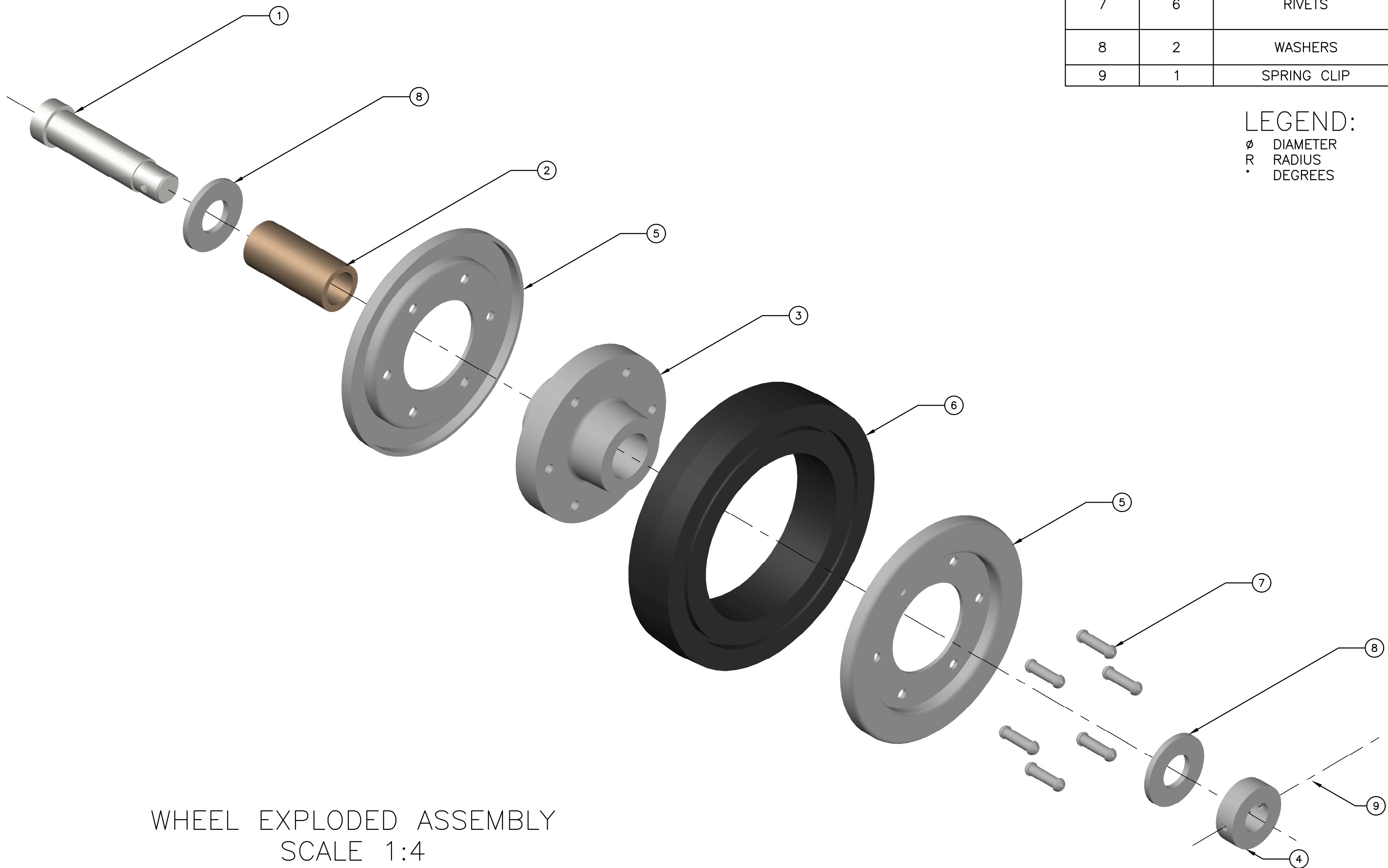

WHEEL EXPLODED ASSEMBLY  
SCALE 1:4

PARTS LIST		
ITEM	QTY	PART NAME
1	1	SHAFT
2	1	BUSHING
3	1	HUB
4	1	COLLAR
5	2	PANEL RING
6	1	WHEEL
7	6	RIVETS
8	2	WASHERS
9	1	SPRING CLIP

LEGEND:  
 ∅ DIAMETER  
 R RADIUS  
 ° DEGREES

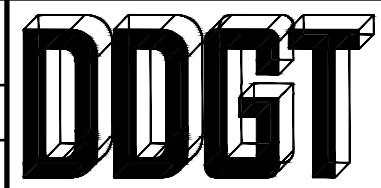

DIGITAL DESIGN  
 GRAPHICS  
 TECHNOLOGY

WWW.DDGT.NET

GENERAL NOTES:  
 ALL FILLETS HAVE  
 R.12" UNLESS  
 OTHERWISE NOTED.

ALL CHAMFERS ARE  
 .06 X 45° UNLESS  
 OTHERWISE NOTED

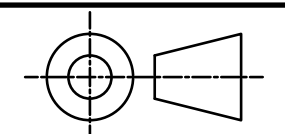

TOLERANCES UNLESS SPECIFIED:  
 DECIMAL INCHES:  
 X = ±.020  
 XX = ±.010  
 XXX = ±.005  
 FRACTIONAL ±1/64"  
 ANGLES ±1 DEGREE  
 SURFACES 32/

CLASS: DDGT 121

ASSIGNMENT #: 09

AUTOCAD DRAWING NAME:  
 WHEEL ASSEMBLY

FIG #: 11-55

MANAGER: G. STROMMEN

DRAFTER: A. MOSTAFA

DATE: 2/21/2023

SCALE: AS NOTED

PAGE #: 2 OF 3



DIGITAL DESIGN  
GRAPHICS  
TECHNOLOGY

WWW.DDGT.NET

GENERAL NOTES:  
ALL FILLETS HAVE  
R.12" UNLESS  
OTHERWISE NOTED.

ALL CHAMFERS ARE  
.06 X 45° UNLESS  
OTHERWISE NOTED

### PARTS LIST

ITEM	QTY	PART NAME
1	1	SHAFT
2	1	BUSHING
3	1	HUB
4	1	COLLAR
5	2	PANEL RING
6	1	WHEEL
7	6	RIVETS
8	2	WASHERS
9	1	SPRING CLIP

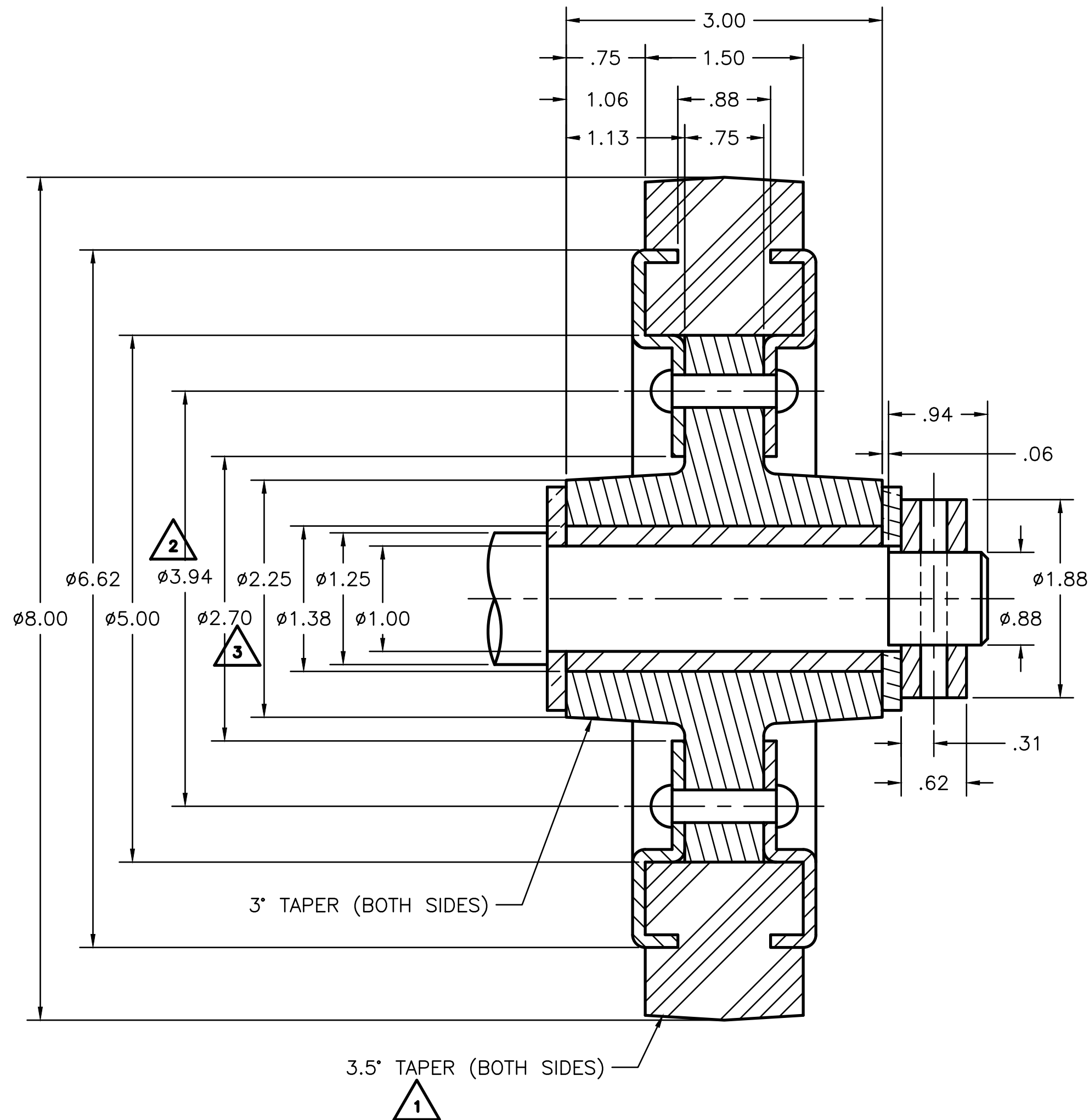

LEGEND:  
 $\phi$  DIAMETER  
 R RADIUS  
 ° DEGREES

REV #	DATE	DESCRIPTION	APPROVED BY
3	2/21/2023	INSIDE DIAMETER OF PANEL RING CHANGED FROM $\phi 2.80$ " TO $\phi 2.70$ "	G. STROMMEN
2	2/21/2023	CENTERLINE DIAMETER FOR RIVET PATTERN CHANGED FROM $\phi 3.5$ " TO $\phi 3.94$ "	G. STROMMEN
1	2/21/2023	TAPER ANGLE ON WHEEL CHANGED FROM 5° TO 3.5°	G. STROMMEN

### REVISION TABLE

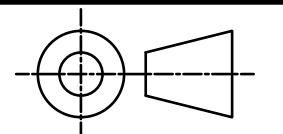

TOLERANCES UNLESS SPECIFIED:  
 DECIMAL INCHES:  
 X =  $\pm .020$   
 XX =  $\pm .010$   
 XXX =  $\pm .005$   
 FRACTIONAL  $\pm 1/64$ "  
 ANGLES  $\pm 1$  DEGREE  
 SURFACES  $\sqrt{32}$

CLASS: DDGT 121

ASSIGNMENT #: 09

AUTOCAD DRAWING NAME:  
WHEEL ASSEMBLY

FIG #: 11-55

MANAGER: G. STROMMEN

DRAFTER: A. MOSTAFA

DATE: 2/21/2023

SCALE: AS NOTED

PAGE #: 3 OF 3