

LEGEND

- ∅ DIAMETER
- R RADIUS
- DEGREES

METRIC

Parts List

ITEM	QTY.	PART NAME	MATERIAL	DESCRIPTION
1	1	AXLE	STEEL	DESCRIPTION
2	1	BUSHING	BRONZE	OILESS
3	1	HUB	ALLUMINUM	
4	1	COLLAR	ALLUMINUM	
5	2	PANEL RING	ALLUMINUM	.12" UNIFORM THICKNESS
6	1	WHEEL		
7	6	RIVETS	STANDARD	∅.31, 1.00" INSIDE LENGTH
8	2	WASHERS	STANDARD	I.D ∅1.00", O.D ∅2.12", .18" THICK
9	1	SPRING PIN	STANDARD	∅.25, 1.875" LONG

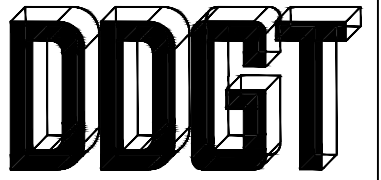

DIGITAL DESIGN GRAPHICS TECHNOLOGY

WWW.DDGT.NET

GENERAL NOTES:
 ALL FILLETS HAVE R.12" UNLESS OTHERWISE NOTED
 ALL CHAMFERS ARE .06" X 45° UNLESS OTHERWISE NOTED

WHEEL ASSEMBLY
SCALE 1:1



WHEEL ASSEMBLY
(ALT VIEW)
SCALE 1:1

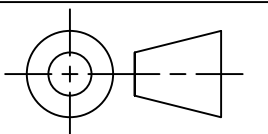

TOLERANCES UNLESS SPECIFIED:
 MILLIMETERS = ±.5:
 X = ±.25
 XX = ±.12
 FRACTIONAL ±1/64"
 ANGLES ±1 DEGREE
 SURFACES 3/2

REV #	DATE	DESCRIPTION	APPROVED BY	PAGE #
3	2/19/2024	INSIDE DIAMETER OF PANEL RING CHANGED FROM ∅2.80" TO ∅2.70"	N.CABADING	3
2	2/19/2024	CENTER LINE DIAMETER FOR RIVET PATTERN CHANGED FROM ∅3.50" TO ∅3.94"	N.CABADING	3
1	2/19/2024	TAPER ANGLE ON WHEEL CHANGED FROM 5° TO 3.5°	N.CABADING	3

REVISION TABLE

CLASS: DDGT121
 ASSIGNMENT #: 9
 AUTOCAD DRAWING NAME: WHEEL ASSEMBLY
 FIG #: 11-55
 MANAGER: G. STROMEN
 DRAFTER: N. CABADING
 DATE: 2/19/2024
 SCALE: AS NOTED
 PAGE #: 1 OF 3

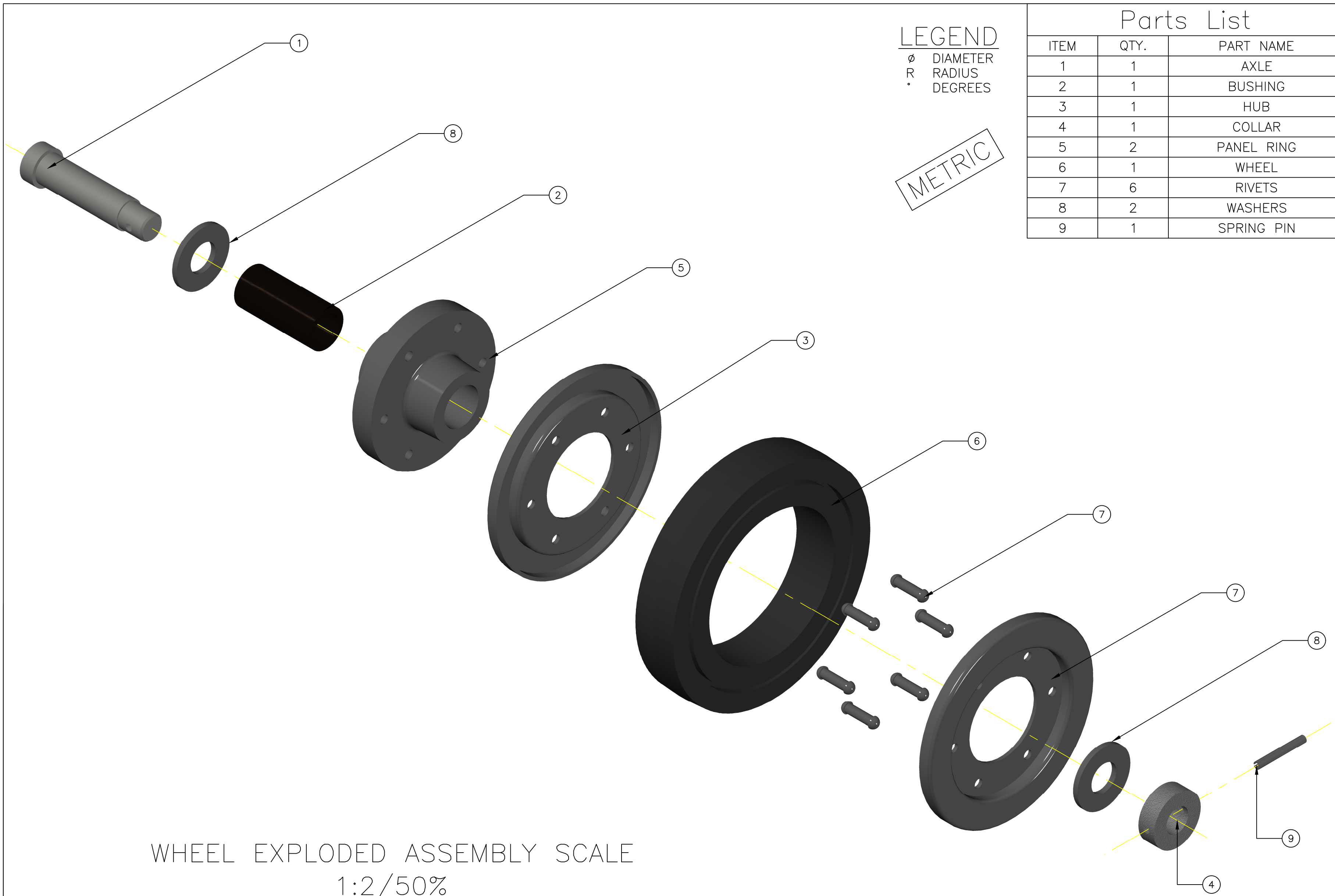

LEGEND

∅ DIAMETER
 R RADIUS
 ° DEGREES

METRIC

Parts List

ITEM	QTY.	PART NAME
1	1	AXLE
2	1	BUSHING
3	1	HUB
4	1	COLLAR
5	2	PANEL RING
6	1	WHEEL
7	6	RIVETS
8	2	WASHERS
9	1	SPRING PIN



DIGITAL DESIGN
 GRAPHICS
 TECHNOLOGY

WWW.DDGT.NET

GENERAL NOTES:
 ALL FILLETS HAVE
 R.12" UNLESS
 OTHERWISE NOTED
 ALL CHAMFERS ARE
 .06" X 45°
 UNLESS OTHERWISE
 NOTED

WHEEL EXPLODED ASSEMBLY SCALE
 1:2/50%

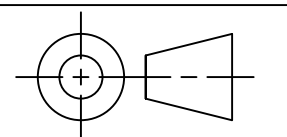

TOLERANCES UNLESS SPECIFIED:
 MILLIMETERS = ±.5:
 X = ±.25
 XX = ±.12
 FRACTIONAL ±1/64"
 ANGLES ±1 DEGREE
 SURFACES 32/

CLASS:	DDGT121
ASSIGNMENT #:	9
AUTOCAD DRAWING NAME:	WHEEL ASSEMBLY
FIG #:	11-55
MANAGER:	G. STROMEN
DRAFTER:	N. CABADING
DATE:	2/19/2024
SCALE:	AS NOTED
PAGE #:	2 OF 3



DIGITAL DESIGN
GRAPHICS
TECHNOLOGY

WWW.DDGT.NET

GENERAL NOTES:
ALL FILLETS HAVE
R.12" UNLESS
OTHERWISE NOTED
ALL CHAMFERS ARE
.06" X 45°
UNLESS OTHERWISE
NOTED

Parts List

ITEM	QTY.	PART NAME
1	1	AXLE
2	1	BUSHING
3	1	HUB
4	1	COLLAR
5	2	PANEL RING
6	1	WHEEL
7	6	RIVETS
8	2	WASHERS
9	1	SPRING PIN

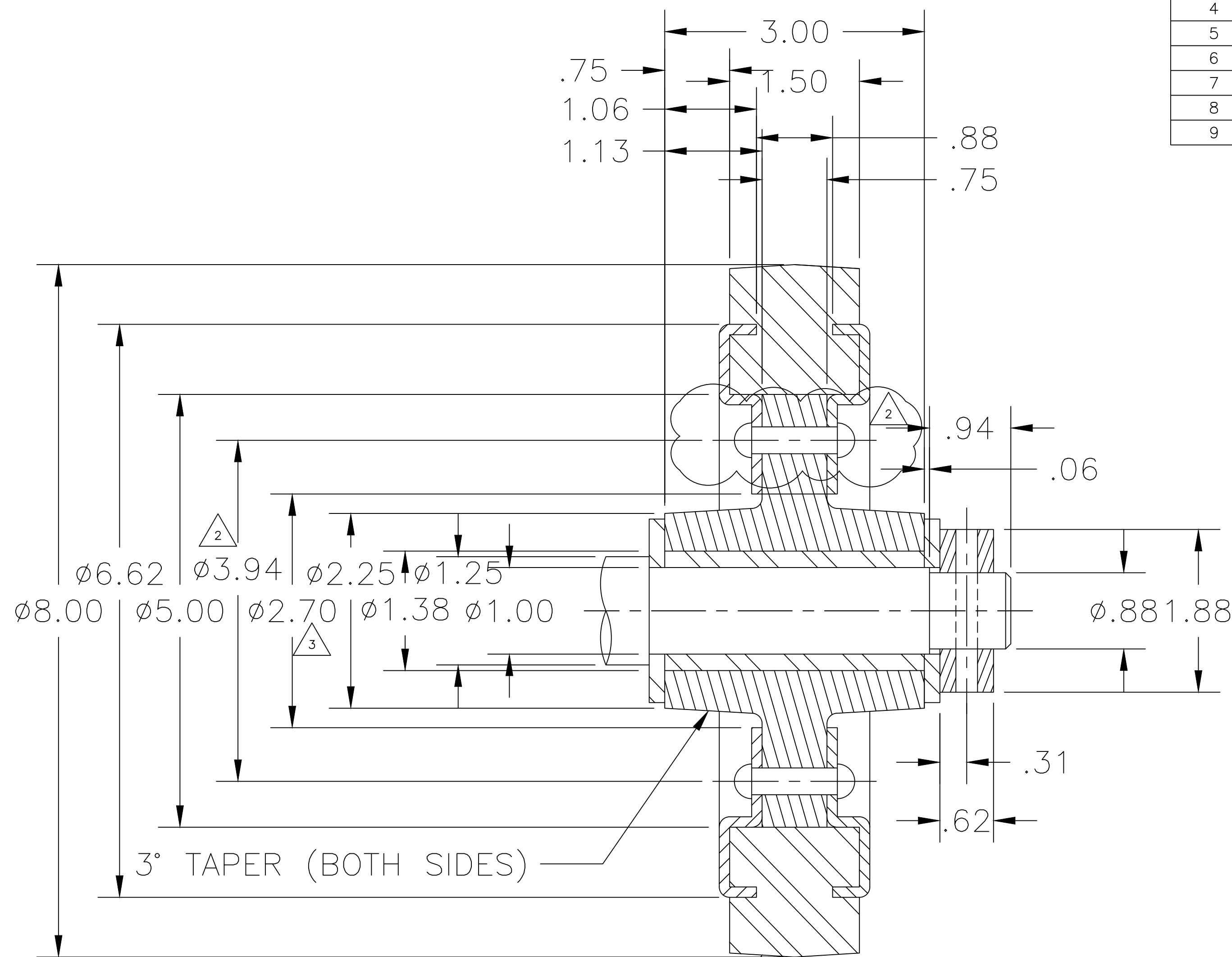

LEGEND

∅ DIAMETER
R RADIUS
° DEGREES

METRIC

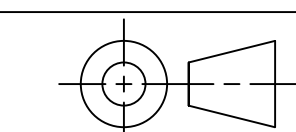

TOLERANCES UNLESS SPECIFIED:
MILLIMETERS = ±.5:
X = ±.25
XX = ±.12
FRACTIONAL ±1/64"
ANGLES ±1 DEGREE
SURFACES 32/

△ 3.5° TAPER (BOTH SIDES)

REV #	DATE	DESCRIPTION	APPROVED BY
3	2/19/2024	INSIDE DIAMETER OF PANEL RING CHANGED FROM ø2.80" TO ø2.70"	N.CABADING
2	2/19/2024	CENTER LINE DIAMETER FOR RIVET PATTERN CHANGED FROM ø3.50" TO ø3.94"	N.CABADING
1	2/19/2024	TAPER ANGLE ON WHEEL CHANGED FROM 5° TO 3.5°	N.CABADING

REVISION TABLE

CLASS:	DDGT121
ASSIGNMENT #:	9
AUTOCAD DRAWING NAME:	WHEEL ASSEMBLY
FIG #:	11-55
MANAGER:	G. STROMEN
DRAFTER:	N. CABADING
DATE:	2/19/2024
SCALE:	AS NOTED
PAGE #:	3 OF 3