

PARTS LIST				
ITEM	QTY	PART NUMBER	MATERIAL	DESCRIPTION
1	1	Axle	STEEL	
2	1	Bushing	BRONZE	OILESS
3	1	Hub	ALUMINUM	
4	1	Collar	ALUMINUM	
5	2	Panel Ring	ALUMINUM	.12" UNIFORM THICKNESS
6	1	Wheel	HARD RUBBER	
7	6	Rivet	STANDARD	Ø31,1.00" INSIDE LENGTH, EQUALLY SPACED
8	2	Washer	STANDARD	I.D. Ø1.00", O.D.Ø2.12", .18" THICK
9	1	SPRING PIN	STANDARD	SPINØ.25", 1.875" LONG (MCMASTER-CARR 92373A380)



WWW.DDGT.NET
 GENERAL NOTES:
 ALL FILLETS HAVE R.12"
 UNLESS OTHERWISE
 NOTED ALL CHAMFERS
 ARE .06" X 45 Ø
 UNLESS OTHERWISE
 NOTED



WHEEL ASSEMBLY
SCALE 1 / 1

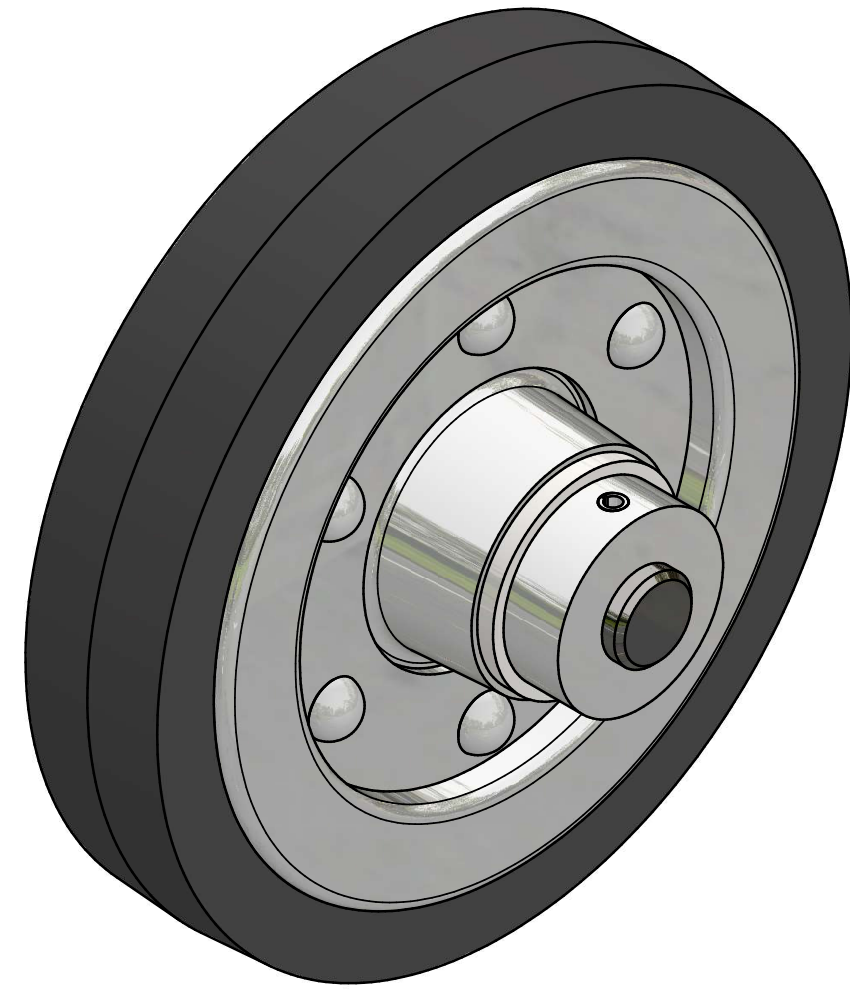

WHEEL ASSEMBLY (ALT VIEW)
SCALE 1 / 1

LEGEND:

- Ø DIAMETER
- R RADIUS
- ° DEGREES
- SPOTFACE/
COUNTERBORE
- ∨ COUNTERSINK
- ∇ DEPTH
- CUBED

GENERAL NOTES

ALL FILLETS HAVE R.12" UNLESS OTHERWISE NOTED ALL CHAMFERS ARE .06" X 45 Ø UNLESS OTHERWISE NOTED

REV	DATE	DESCRIPTION	APPROVED	SHEET
3	3/24/2024	INSIDE DIAMETER OF PANEL RING CHANGED FROM Ø2.80" TO Ø2.70"	G.STROMMEN	3
2	3/24/2024	CENTERLINE DIAMETER FOR RIVET PATTERN CHANGED FROM Ø3.50" TO Ø3.94"	G.STROMMEN	3
1	3/24/2024	TAPER ANGLE ON WHEEL CHANGED FROM 5° TO 3.5°	G.STROMMEN	3

REVISION HISTORY

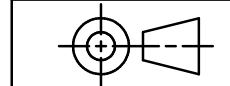

TOLERANCES UNLESS SPECIFIED:
 DECIMAL INCHES:
 X= ±.020
 XX= ±.010
 XXX= ±.005
 FRACTIONAL ± 1/64"
 ANGLES ±1 DEGREE
 SURFACES 32

CLASS: DDGT121

ASSIGNMENT #:

INVENOR DRAWING NAME:
WHEEL ASSEMBLY

FIG #: 11-55

MANAGER: G. STROMMEN

DRAFTER: N.CABADING

DATE: 3/12/2024

SCALE: AS NOTED

PAGE #: 1 OF 3

GENERAL NOTES

ALL FILLETS HAVE R.12" UNLESS OTHERWISE NOTED ALL CHAMFERS ARE .06" X 45 ° UNLESS OTHERWISE NOTED

PARTS LIST		
ITEM	QTY	PART NUMBER
1	1	Axle
2	1	Bushing
3	1	Hub
4	1	Collar
5	2	Panel Ring
6	1	Wheel
7	6	Rivet
8	2	Washer
9	1	SPRING PIN



DIGITAL DESIGN
GRAPHICS
TECHNOLOGY

WWW.DDGT.NET

GENERAL NOTES:

ALL FILLETS HAVE R.12"
UNLESS OTHERWISE
NOTED ALL CHAMFERS
ARE .06" X 45 °
UNLESS OTHERWISE
NOTED

LEGEND:

- ∅ DIAMETER
- R RADIUS
- ° DEGREES
- SPOTFACE/
COUNTERBORE
- ∇ COUNTERSINK
- ▽ DEPTH
- CUBED

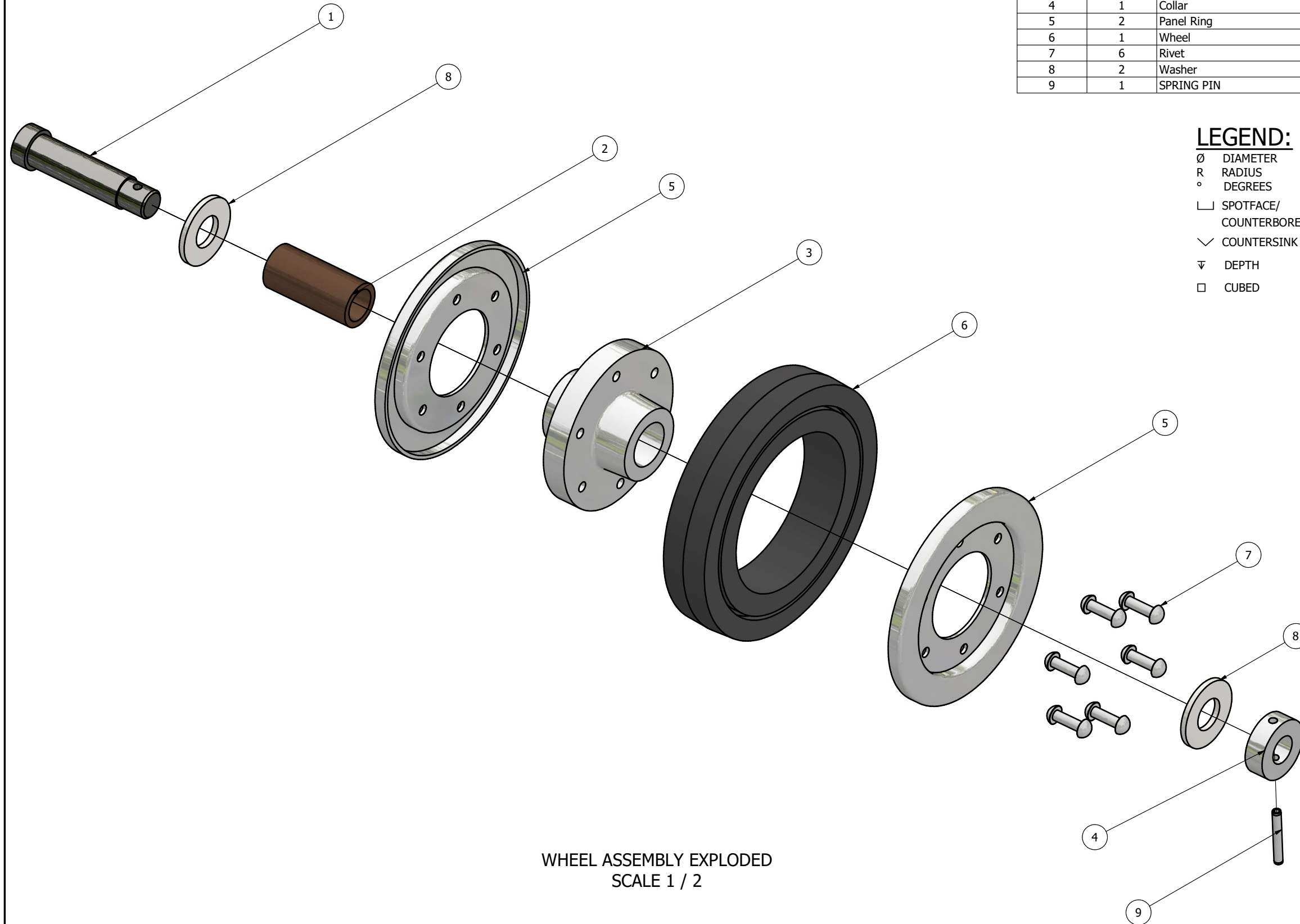

WHEEL ASSEMBLY EXPLODED
SCALE 1 / 2

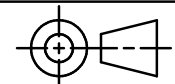

TOLERANCES UNLESS SPECIFIED:
DECIMAL INCHES:
X= ±.020
XX= ±.010
XXX= ±.005
FRACTIONAL ± 1/64"
ANGLES ±1 DEGREE
SURFACES 32

CLASS: DDGT121

ASSIGNMENT #:

INVENOR DRAWING NAME:

WHEEL ASSEMBLY

FIG #: 11-55

MANAGER: G. STROMMEN

DRAFTER: N.CABADING

DATE: 3/12/2024

SCALE: AS NOTED

PAGE #: 2 OF 3

PARTS LIST		
ITEM	QTY	PART NUMBER
1	1	Axle
2	1	Bushing
3	1	Hub
4	1	Collar
5	2	Panel Ring
6	1	Wheel
7	6	Rivet
8	2	Washer
9	1	SPRING PIN

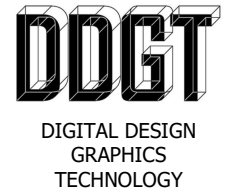

WWW.DDGT.NET

GENERAL NOTES:
 ALL FILLETS HAVE R.12"
 UNLESS OTHERWISE
 NOTED ALL CHAMFERS
 ARE .06" X 45 Ø
 UNLESS OTHERWISE
 NOTED

LEGEND:

- Ø DIAMETER
- R RADIUS
- ° DEGREES
- SPOTFACE/
COUNTERBORE
- ∇ COUNTERSINK
- ∇ DEPTH
- CUBED

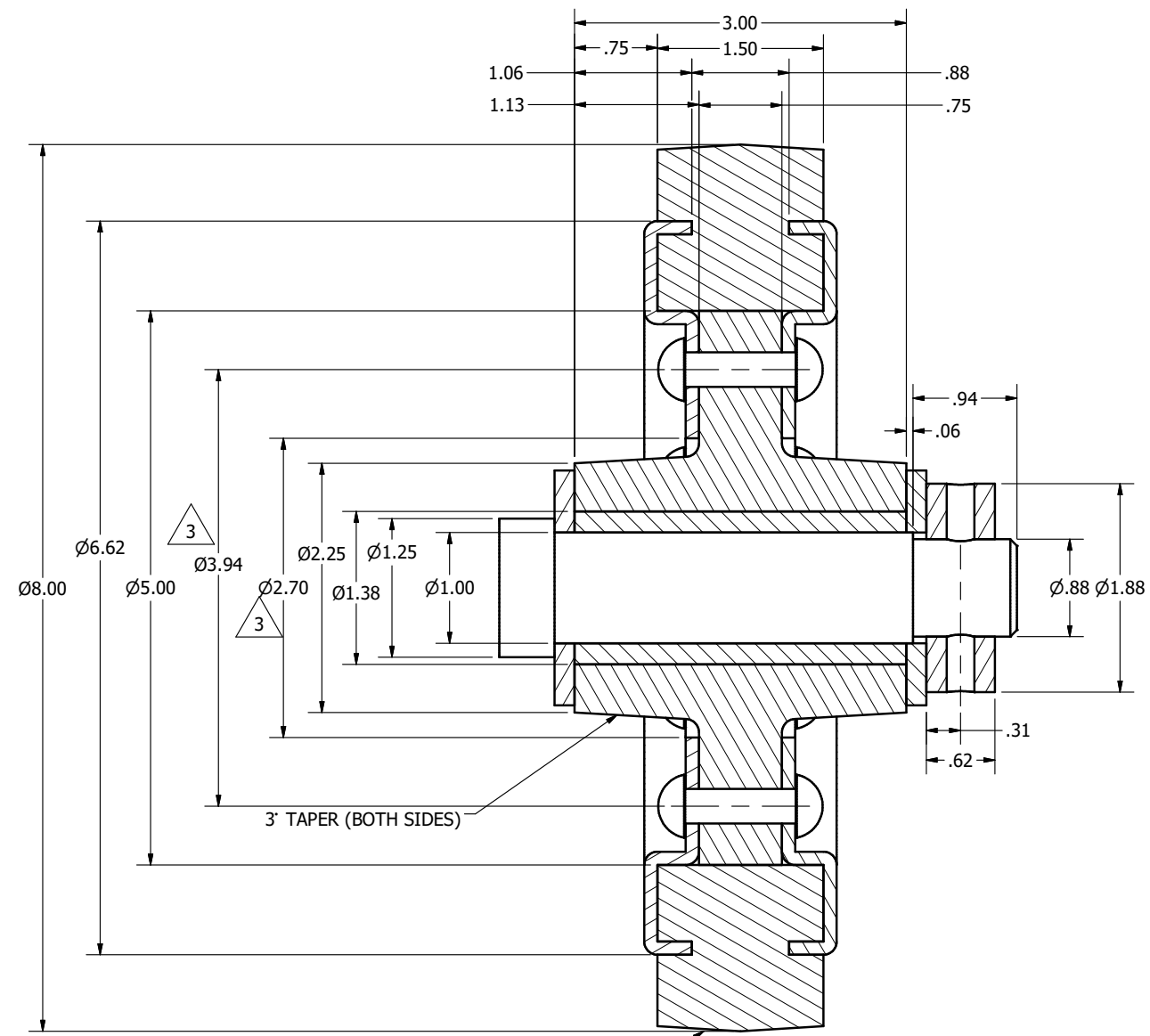

3 3.5° TAPER (BOTH SIDES)

WHEEL SECTION VIEW
SCALE 1 / 1

GENERAL NOTES

ALL FILLETS HAVE R.12" UNLESS OTHERWISE NOTED ALL CHAMFERS ARE .06" X 45 Ø UNLESS OTHERWISE NOTED

REV	DATE	DESCRIPTION	APPROVED
3	3/24/2024	INSIDE DIAMETER OF PANEL RING CHANGED FROM Ø2.80" TO Ø2.70"	G.STROMMEN
2	3/24/2024	CENTERLINE DIAMETER FOR RIVET PATTERN CHANGED FROM Ø3.50" TO Ø3.94"	G.STROMMEN
1	3/24/2024	TAPER ANGLE ON WHEEL CHANGED FROM 5° TO 3.5°	G.STROMMEN
REVISION HISTORY			

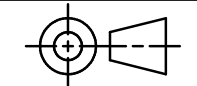

TOLERANCES UNLESS SPECIFIED:
 DECIMAL INCHES:
 X= ±.020
 XX= ±.010
 XXX= ±.005
 FRACTIONAL ± 1/64"
 ANGLES ±1 DEGREE
 SURFACES 32

CLASS: DDGT121

ASSIGNMENT #:

INVENOR DRAWING NAME:

WHEEL ASSEMBLY

FIG #: 11-55

MANAGER: G. STROMMEN

DRAFTER: N.CABADING

DATE: 3/12/2024

SCALE: AS NOTED

PAGE #: 3 OF 3