

DIGITAL DESIGN  
GRAPHICS  
TECHNOLOGY

WWW.DDGT.NET

GENERAL NOTES:  
ALL FILLETS HAVE R.12"  
UNLESS OTHERWISE  
NOTED  
ALL CHAMFERS ARE .06"  
X 45° UNLESS  
OTHERWISE NOTED

| PARTS LIST |     |             |             |   |
|------------|-----|-------------|-------------|---|
| ITEM       | QTY | PART NUMBER | MATERIAL    | DESCRIPTION   |
| 1          | 1   | AXLE        | STEEL       |   |
| 2          | 1   | BUSHING     | BRONZE      | OILESS  |
| 3          | 1   | HUB         | ALUMINUM    |   |
| 4          | 1   | COLLAR      | ALUMINUM    |   |
| 5          | 2   | PANEL RING  | ALUMINUM    | .12" UNIFORM THICKNESS  |
| 6          | 1   | WHEEL       | HARD RUBBER |   |
| 7          | 6   | RIVET       | STANDARD    | Ø.31, 1.00" INSIDE LENGTH,<br>EQUALLY SPACED<br>(MCMASTER-CARR 97300A709) |
| 8          | 2   | WASHER      | STANDARD    | I.D. Ø1.00", O.D. Ø2.12", .18"<br>THICK                                   |
| 9          | 1   | SPRING PIN  | STANDARD    | Ø.25", 1.875" LONG<br>(MCMASTER-CARR 98296A932)                           |

**LEGEND:**

Ø DIAMETER  
R RADIUS  
° DEGREES

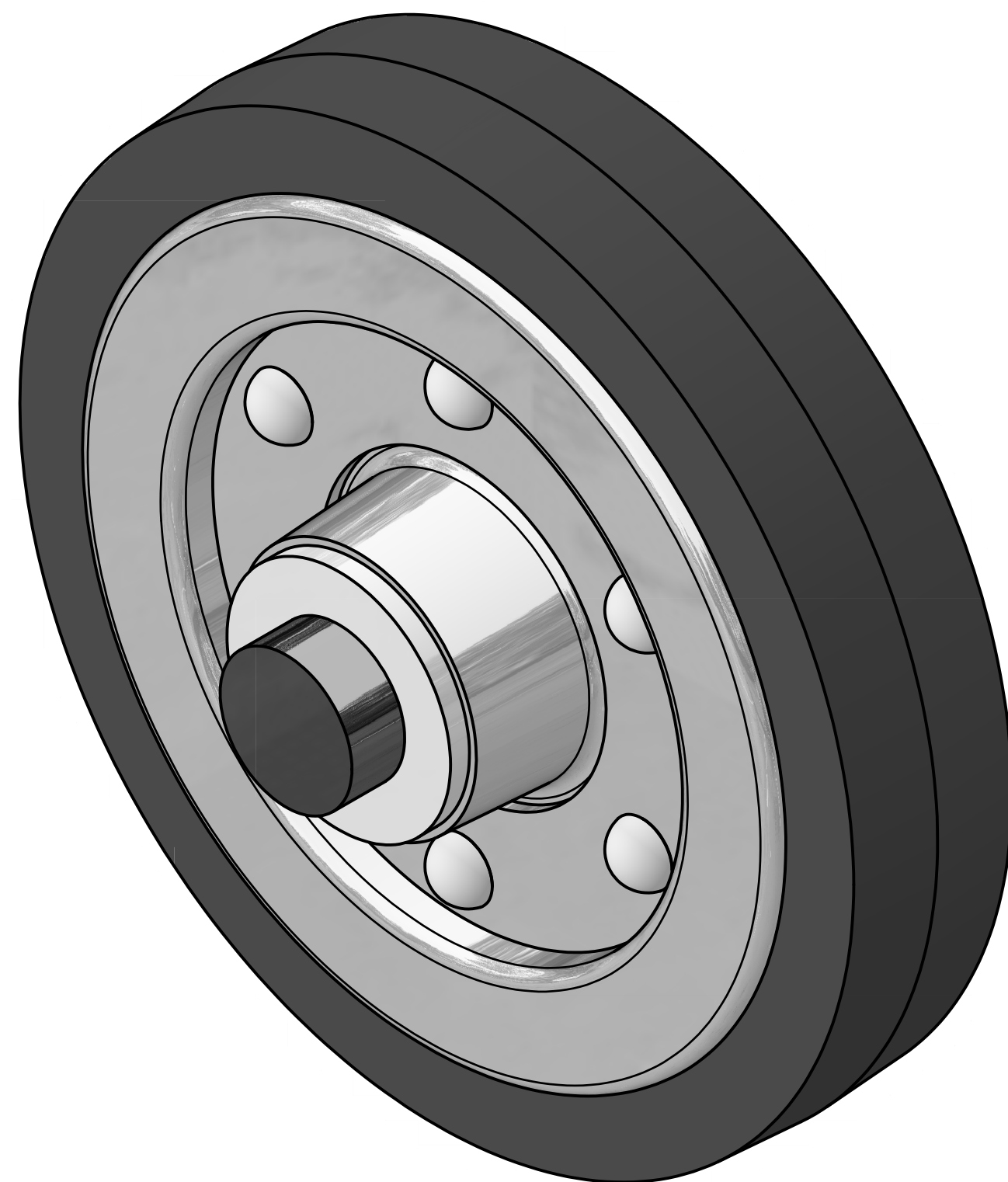

WHEEL ASSEMBLY  
SCALE 1 : 1

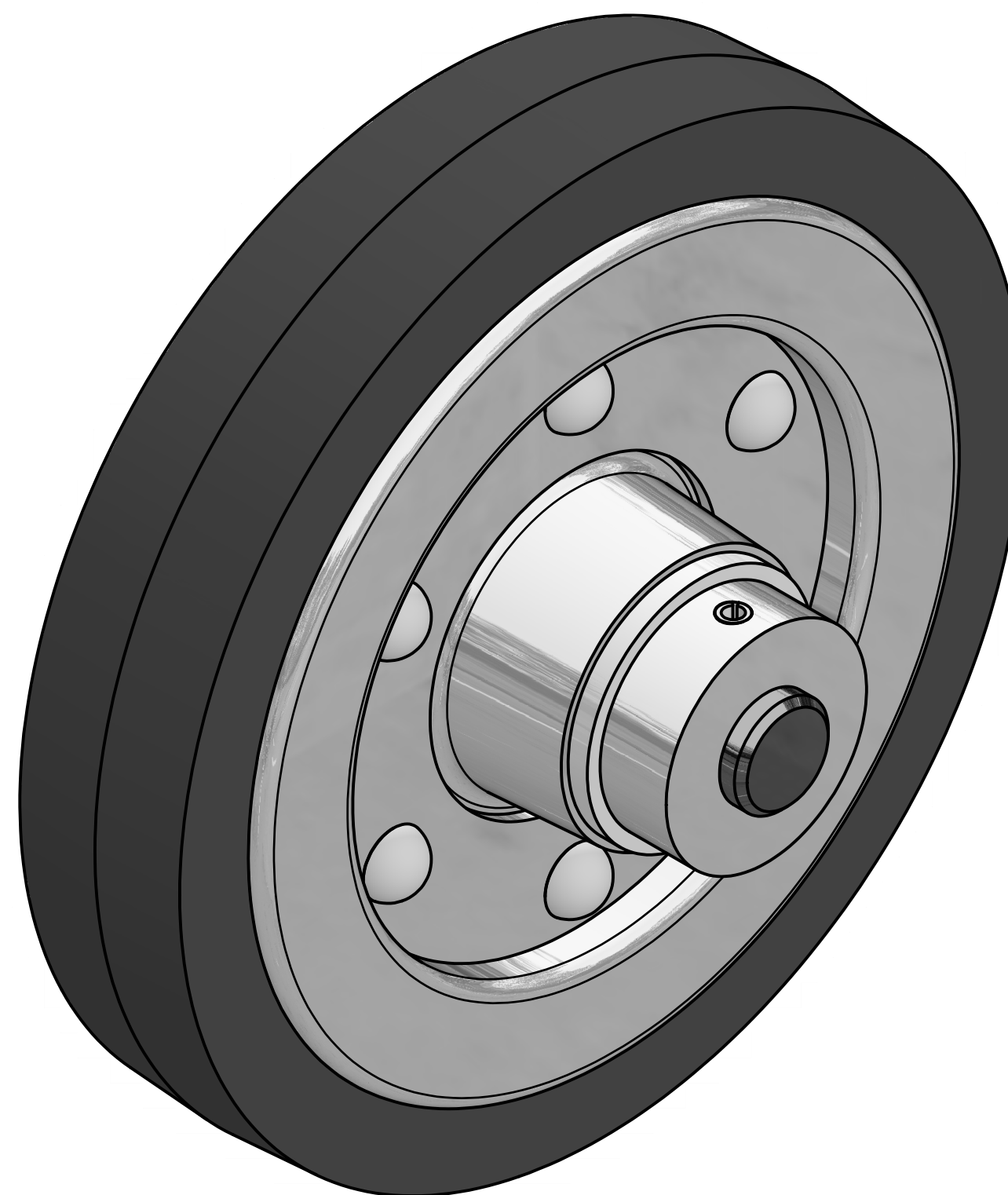

WHEEL ASSEMBLY (ALT)  
SCALE 1 : 1

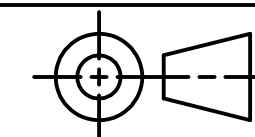

TOLERANCES UNLESS SPECIFIED:  
DECIMAL INCHES:  
X = ±.020  
XX = ±.010  
XXX = ±.005  
FRACTIONAL ±1/64"  
ANGLES ±1 DEGREE

SURFACES <sup>32</sup> ✓

CLASS: DDGT 121

ASSIGNMENT #: #11

INVENTOR DRAWING NAME:

WHEEL ASSEMBLY

FIG #: 11-55

MANAGER: G. STROMMEN

DRAFTER: S. ZEPEDA

DATE: 2/22/2023

SCALE: AS NOTED

PAGE #: 1 OF 3

| REV              | DATE      | DESCRIPTION   | APPROVED    | SHEET |
|------------------|-----------|---|-------------|-------|
| 3                | 2/25/2023 | INSIDE DIAMETER OF PANEL RING CHANGED FROM Ø2.80" TO Ø2.70"         | G. STROMMEN | 3     |
| 2                | 2/25/2023 | CENTERLINE DIAMETER FOR RIVET PATTERN CHANGED FROM Ø3.50" TO Ø3.94" | G. STROMMEN | 3     |
| 1                | 2/25/2023 | TAPER ANGLE ON WHEEL CHANGED FROM 5° TO 3.5°                        | G. STROMMEN | 3     |
| REVISION HISTORY |           |   |             |       |

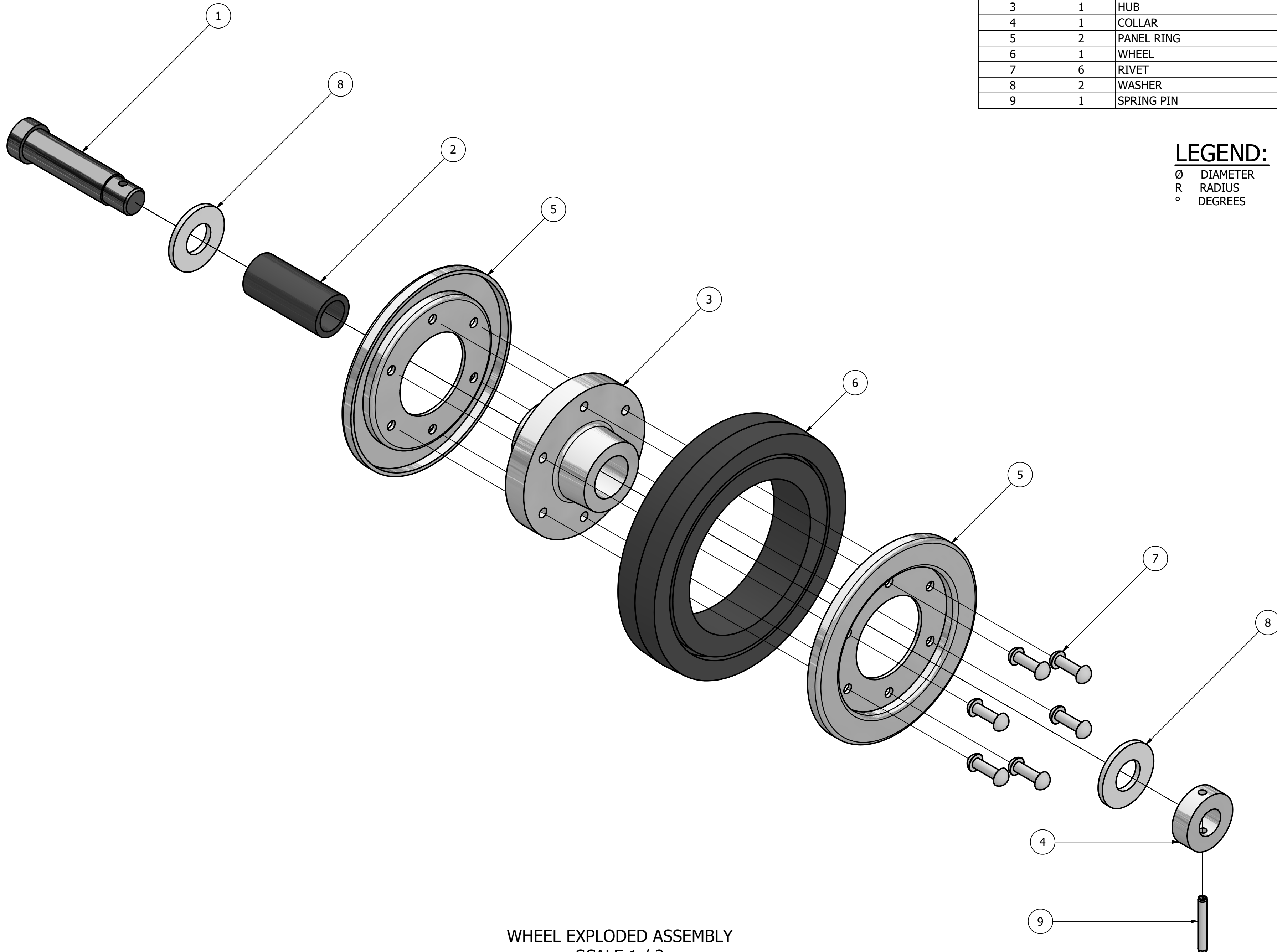

| PARTS LIST |     |             |
|------------|-----|-------------|
| ITEM       | QTY | PART NUMBER |
| 1          | 1   | AXLE        |
| 2          | 1   | BUSHING     |
| 3          | 1   | HUB         |
| 4          | 1   | COLLAR      |
| 5          | 2   | PANEL RING  |
| 6          | 1   | WHEEL       |
| 7          | 6   | RIVET       |
| 8          | 2   | WASHER      |
| 9          | 1   | SPRING PIN  |

**DDGT**  
 DIGITAL DESIGN  
 GRAPHICS  
 TECHNOLOGY  
 WWW.DDGT.NET

GENERAL NOTES:  
 ALL FILLETS HAVE R.12"  
 UNLESS OTHERWISE  
 NOTED  
 ALL CHAMFERS ARE .06"  
 X 45° UNLESS  
 OTHERWISE NOTED

**LEGEND:**  
 Ø DIAMETER  
 R RADIUS  
 ° DEGREES

TOLERANCES UNLESS SPECIFIED:  
 DECIMAL INCHES:  
 X = ±.020  
 XX = ±.010  
 XXX = ±.005  
 FRACTIONAL ±1/64"  
 ANGLES ±1 DEGREE

SURFACES  $\sqrt{\text{V}}$

CLASS: DDGT 121  
 ASSIGNMENT #: #11  
 INVENTOR DRAWING NAME:  
 WHEEL ASSEMBLY  
 FIG #: 11-55  
 MANAGER: G. STROMMEN  
 DRAFTER: S. ZEPEDA  
 DATE: 2/22/2023  
 SCALE: AS NOTED  
 PAGE #: 2 OF 3

WHEEL EXPLODED ASSEMBLY  
 SCALE 1 / 2

| PARTS LIST |     |             |
|------------|-----|-------------|
| ITEM       | QTY | PART NUMBER |
| 1          | 1   | AXLE        |
| 2          | 1   | BUSHING     |
| 3          | 1   | HUB         |
| 4          | 1   | COLLAR      |
| 5          | 2   | PANEL RING  |
| 6          | 1   | WHEEL       |
| 7          | 6   | RIVET       |
| 8          | 2   | WASHER      |
| 9          | 1   | SPRING PIN  |

**DDGT**  
 DIGITAL DESIGN  
 GRAPHICS  
 TECHNOLOGY  
 WWW.DDGT.NET

GENERAL NOTES:  
 ALL FILLETS HAVE R.12"  
 UNLESS OTHERWISE  
 NOTED  
 ALL CHAMFERS ARE .06"  
 X 45° UNLESS  
 OTHERWISE NOTED

**LEGEND:**  
 Ø DIAMETER  
 R RADIUS  
 ° DEGREES

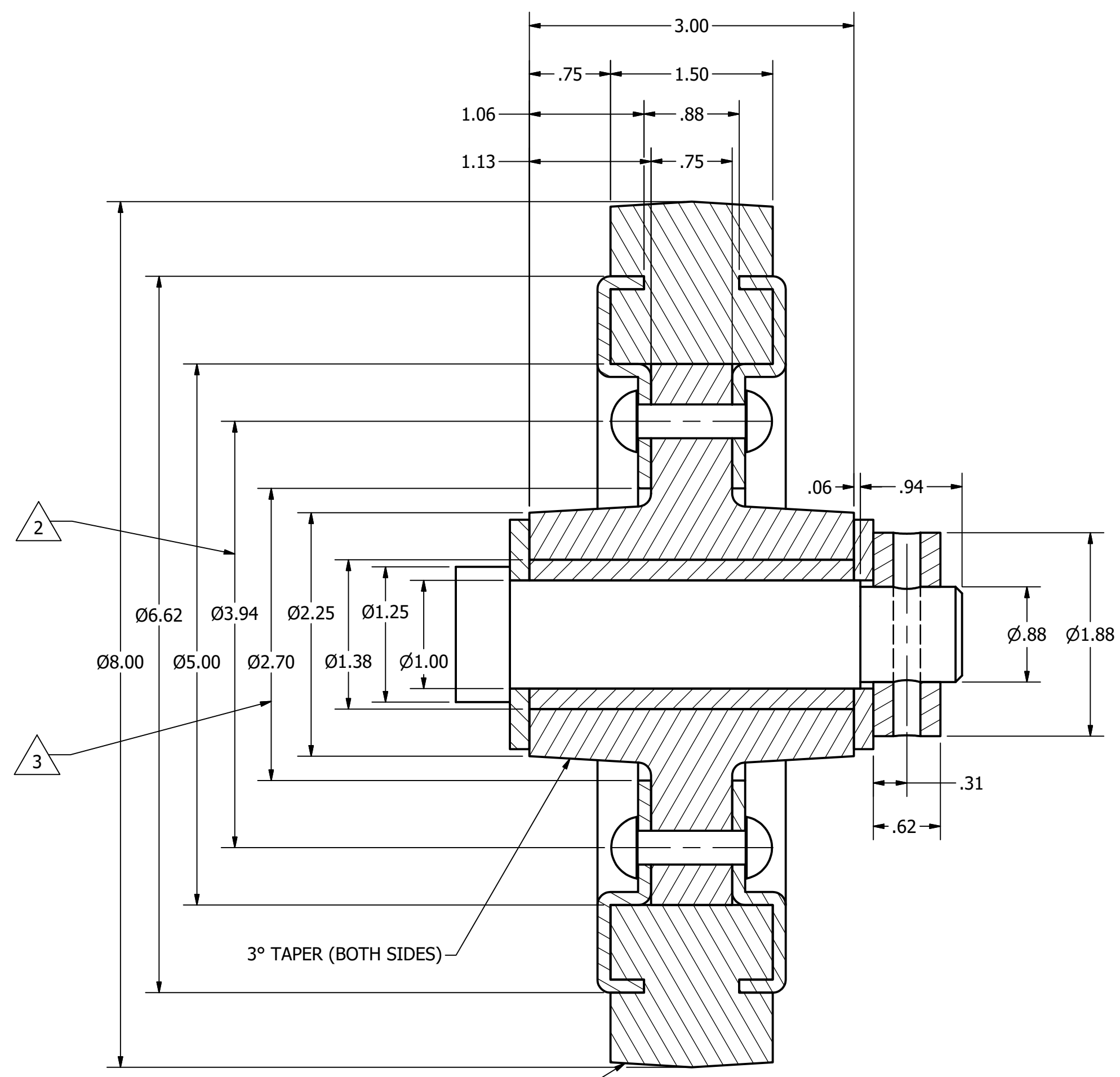

3.5° TAPER (BOTH SIDES)  
 1

WHEEL ASSEMBLY SECTION VIEW  
 SCALE 1 : 1

| REV | DATE      | DESCRIPTION   | APPROVED    | SHEET |
|-----|-----------|---|-------------|-------|
| 3   | 2/25/2023 | INSIDE DIAMETER OF PANEL RING CHANGED FROM Ø2.80" TO Ø2.70"         | G. STROMMEN | 3     |
| 2   | 2/25/2023 | CENTERLINE DIAMETER FOR RIVET PATTERN CHANGED FROM Ø3.50" TO Ø3.94" | G. STROMMEN | 3     |
| 1   | 2/25/2023 | TAPER ANGLE ON WHEEL CHANGED FROM 5° TO 3.5°                        | G. STROMMEN | 3     |
| REV | DATE      | DESCRIPTION   | APPROVED    | SHEET |

REVISION HISTORY

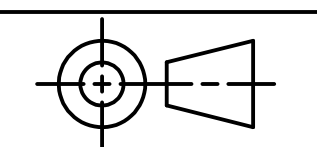

TOLERANCES UNLESS SPECIFIED:  
 DECIMAL INCHES:  
 X = ±.020  
 XX = ±.010  
 XXX = ±.005  
 FRACTIONAL ±1/64"  
 ANGLES ±1 DEGREE  
 SURFACES 32

CLASS: DDGT 121

ASSIGNMENT #: #11

INVENTOR DRAWING NAME:  
 WHEEL ASSEMBLY

FIG #: 11-55

MANAGER: G. STROMMEN

DRAFTER: S. ZEPEDA

DATE: 2/22/2023

SCALE: AS NOTED

PAGE #: 3 OF 3