



DIGITAL DESIGN  
GRAPHICS  
TECHNOLOGY

WWW.DDGT.NET

GENERAL NOTES:  
ALL FILLETS HAVE R.12"  
UNLESS OTHERWISE  
NOTED, ALL CHAMFERS  
ARE .06" X 45° UNLESS  
OTHERWISE NOTED

PARTS LIST

ITEM	QTY	PART NUMBER	MATERIAL	DESCRIPTION
1	1	AXLE	STEEL	
2	1	BUSHING	BRONZE	OILLESS
3	1	HUB	ALUMINUM	
4	1	COLLAR	ALUMINUM	
5	2	PANEL RING	ALUMINUM	.12" UNIFORM THICKNESS
6	1	WHEEL	HARD RUBBER	
7	6	RIVET	STANDARD	∅.31", 1.00" INDSIDE LENGTH (MCMASTER CARR NO.97300A709_Steel)
8	2	WASHER	STANDARD	I.D. 1.00", O.D. 2.12", .18" THICK
9	1	SPRING PIN	STANDARD	∅.25", 1.875" LONG (MCMASTER CARR NO. 98296A932_1050-1095)

LEGEND:

∅ DIAMETER  
R RADIUS  
° DEGREES

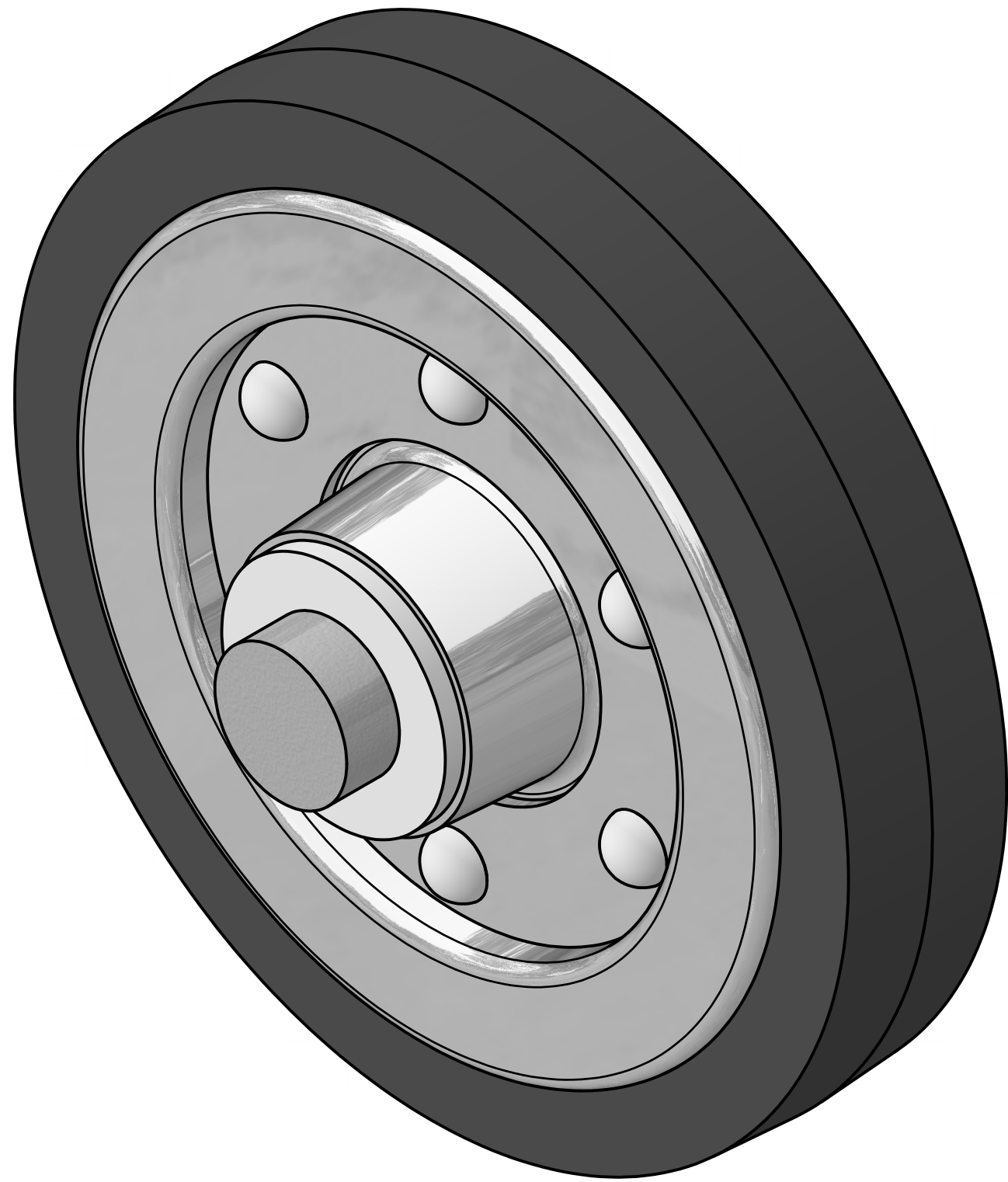

WHEEL ASSEMBLY  
SCALE 1 : 1

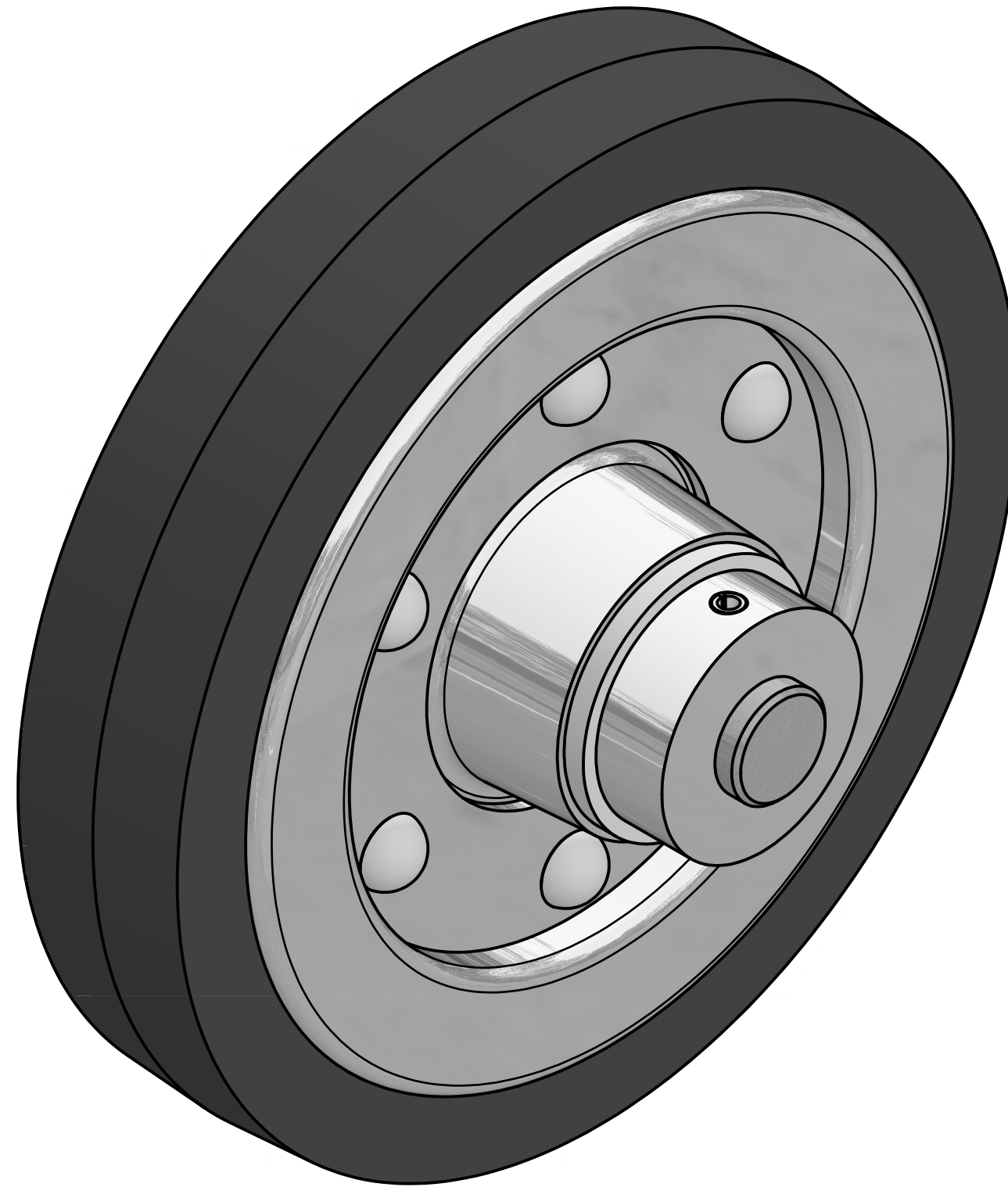

WHEEL ASSEMBLY (ALT VIEW)  
SCALE 1 : 1

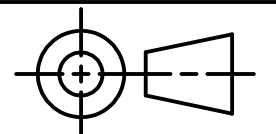

TOLERANCES UNLESS SPECIFIED  
DECIMAL INCHES:  
X = ±.020  
XX = ±.010  
XXX = ±.005  
FRACTIONAL: ±1/64"  
ANGLES ±1 DEGREE

SURFACES <sup>32</sup> ✓

CLASS: DDGT 121

ASSIGNMENT NO.: 11

INVENTOR DRAWING NAME:  
WHEEL ASSEMBLY

FIG NO.: 11-55

MANAGER: G. STROMMEN

DRAFTER: TVIDALES

DATE: 2/18/2024

SCALE: AS NOTED

PAGE NO.: 1 OF 3

REV	DATE	DESCRIPTION	APPROVED	SHEET
3	2/18/2024	INSIDE DIAMETER OF PANEL RING CHANGED FROM ∅2.80" TO ∅2.70"	G. STROMMEN	3
2	2/18/2024	FOR PARTS, "BRACKET" AND "HUB", RIVET HOLE PATTERN DIAMETER CHANGED FROM ∅3.50" TO ∅3.94"	G. STROMMEN	3
1	2/18/2024	ON PART "WHEEL" TAPER ANGLE CHANGED FROM 5° TO 3.5°	G. STROMMEN	3
REVISION HISTORY				

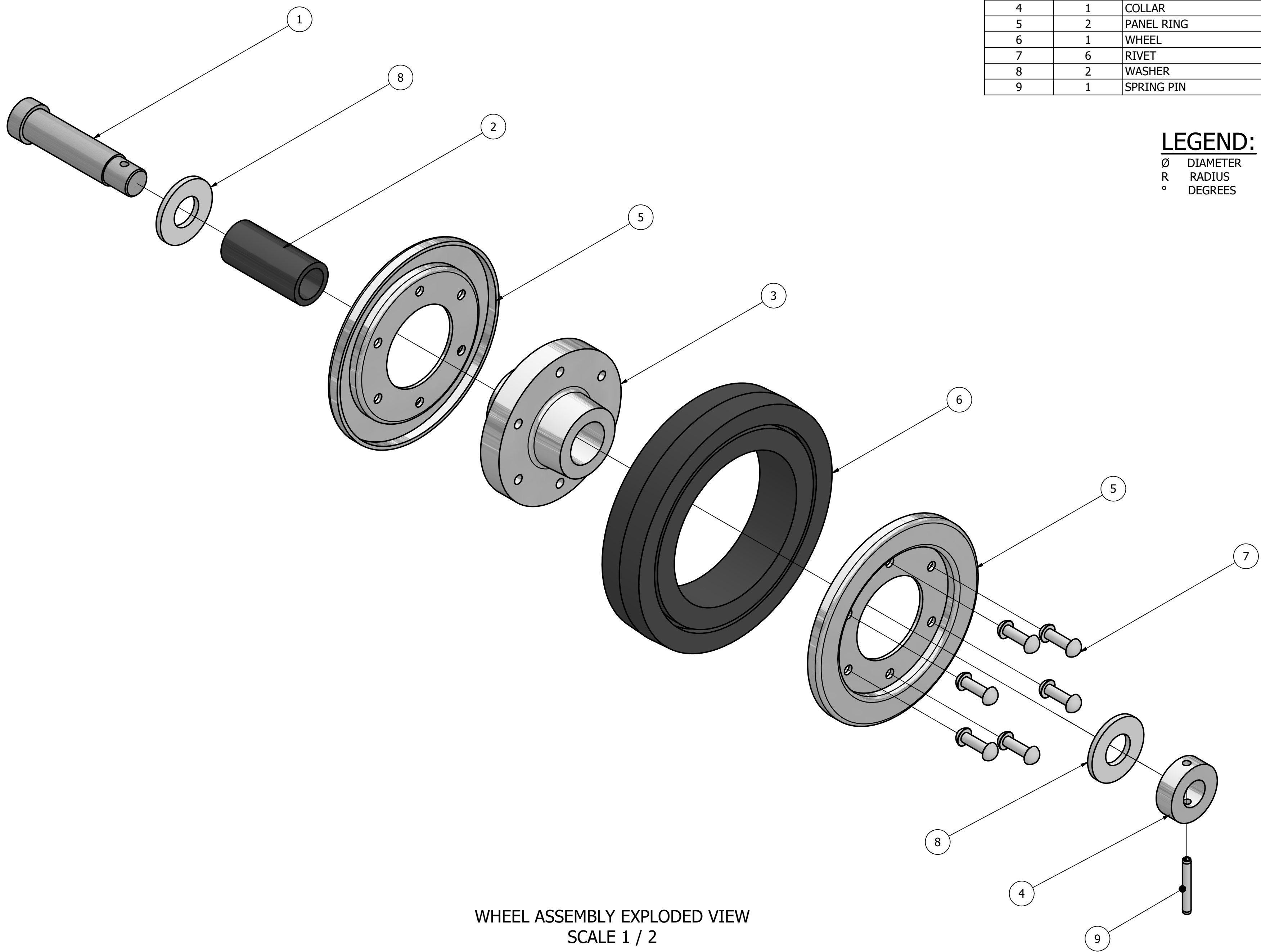

WHEEL ASSEMBLY EXPLODED VIEW  
SCALE 1 / 2

PARTS LIST		
ITEM	QTY	PART NUMBER
1	1	AXLE
2	1	BUSHING
3	1	HUB
4	1	COLLAR
5	2	PANEL RING
6	1	WHEEL
7	6	RIVET
8	2	WASHER
9	1	SPRING PIN



DIGITAL DESIGN  
GRAPHICS  
TECHNOLOGY

WWW.DDGT.NET

GENERAL NOTES:  
ALL FILLETS HAVE R.12"  
UNLESS OTHERWISE  
NOTED, ALL CHAMFERS  
ARE .06" X 45° UNLESS  
OTHERWISE NOTED

**LEGEND:**

- ∅ DIAMETER
- R RADIUS
- ° DEGREES

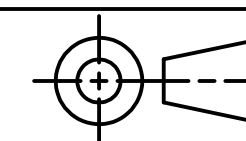

TOLERANCES UNLESS SPECIFIED  
DECIMAL INCHES:  
X = ±.020  
XX = ±.010  
XXX = ±.005  
FRACTIONAL: ±1/64"  
ANGLES ±1 DEGREE

CLASS:	DDGT 121
ASSIGNMENT NO.:	11
INVENTOR DRAWING NAME:	WHEEL ASSEMBLY
FIG NO.:	11-55
MANAGER:	G. STROMMEN
DRAFTER:	TVIDALES
DATE:	2/18/2024
SCALE:	AS NOTED
PAGE NO.:	2 OF 3



DIGITAL DESIGN  
GRAPHICS  
TECHNOLOGY

WWW.DDGT.NET

GENERAL NOTES:

ALL FILLETS HAVE R.12"  
UNLESS OTHERWISE  
NOTED, ALL CHAMFERS  
ARE .06" X 45° UNLESS  
OTHERWISE NOTED

PARTS LIST		
ITEM	QTY	PART NUMBER
1	1	AXLE
2	1	BUSHING
3	1	HUB
4	1	COLLAR
5	2	PANEL RING
6	1	WHEEL
7	6	RIVET
8	2	WASHER
9	1	SPRING PIN

**LEGEND:**

∅ DIAMETER  
R RADIUS  
° DEGREES

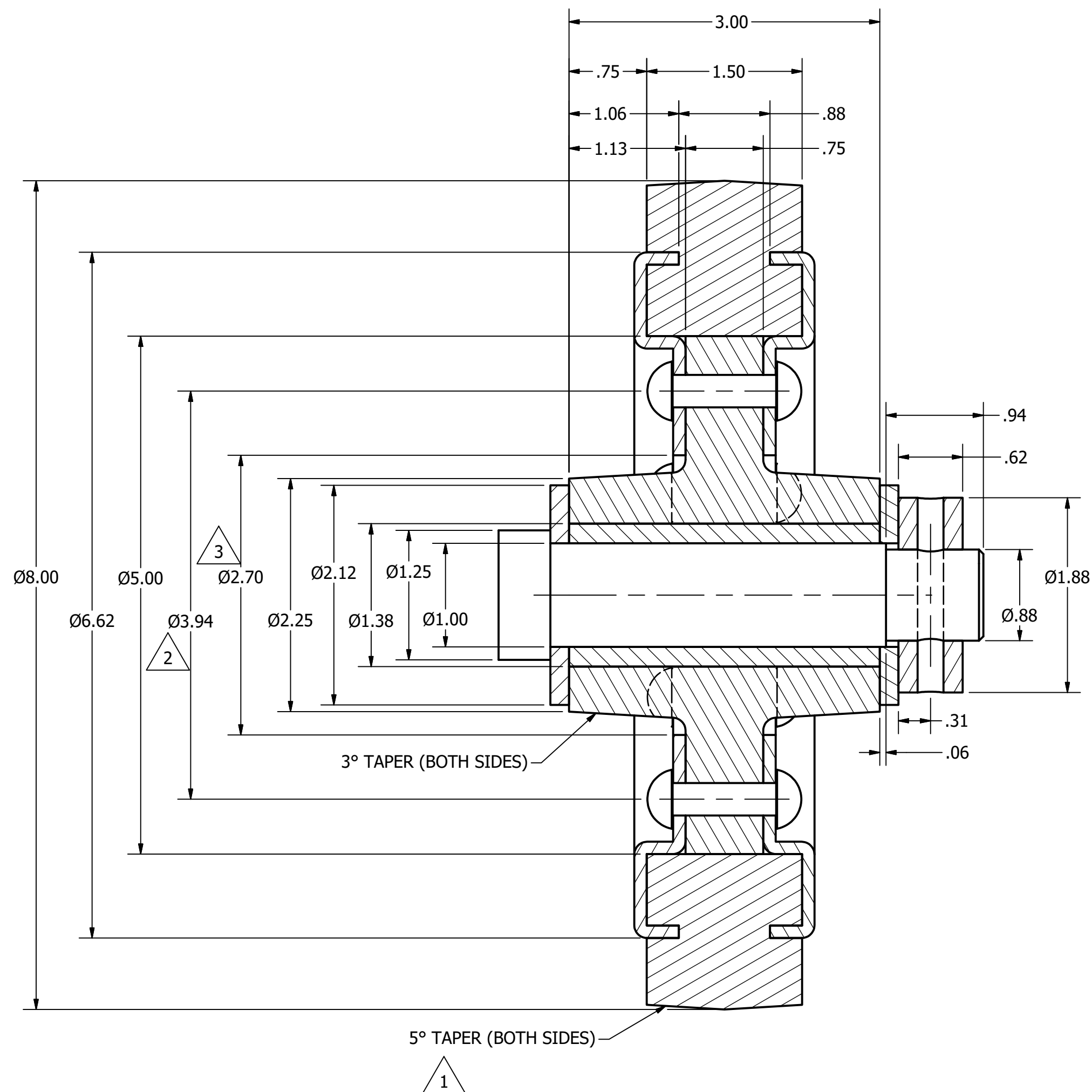

WHEEL ASSEMBLY SECTION VIEW  
SCALE 1 : 1

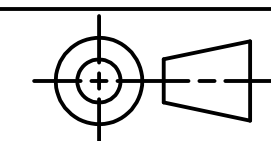

TOLERANCES UNLESS SPECIFIED  
DECIMAL INCHES:  
X = ±.020  
XX = ±.010  
XXX = ±.005  
FRACTIONAL ±1/64"  
ANGLES ±1 DEGREE

CLASS: DDGT 121  
ASSIGNMENT NO.: 11

REV	DATE	DESCRIPTION	APPROVED	SHEET
3	2/18/2024	INSIDE DIAMETER OF PANEL RING CHANGED FROM ∅2.80" TO ∅2.70"	G. STROMMEN	3
2	2/18/2024	FOR PARTS, "BRACKET" AND "HUB", RIVET HOLE PATTERN DIAMETER CHANGED FROM ∅3.50" TO ∅3.94"	G. STROMMEN	3
1	2/18/2024	ON PART "WHEEL" TAPER ANGLE CHANGED FROM 5° TO 3.5°	G. STROMMEN	3
REV	DATE	DESCRIPTION	APPROVED	SHEET

INVENTOR DRAWING NAME:  
WHEEL ASSEMBLY  
FIG NO.: 11-55  
MANAGER: G. STROMMEN  
DRAFTER: TVIDALES  
DATE: 2/18/2024  
SCALE: AS NOTED  
PAGE NO.: 3 OF 3

REVISION HISTORY